

WEMBLEY

10

Transfer to LCC in Trust for Infrastructure Purposes (Future Road) under an Infrastructure Agreement.

1000 m<sup>2</sup> (gross)  
905 m<sup>2</sup> (net)

ROAD

Common Property  
4 m<sup>2</sup>

STREET

Common Property  
4 m<sup>2</sup>

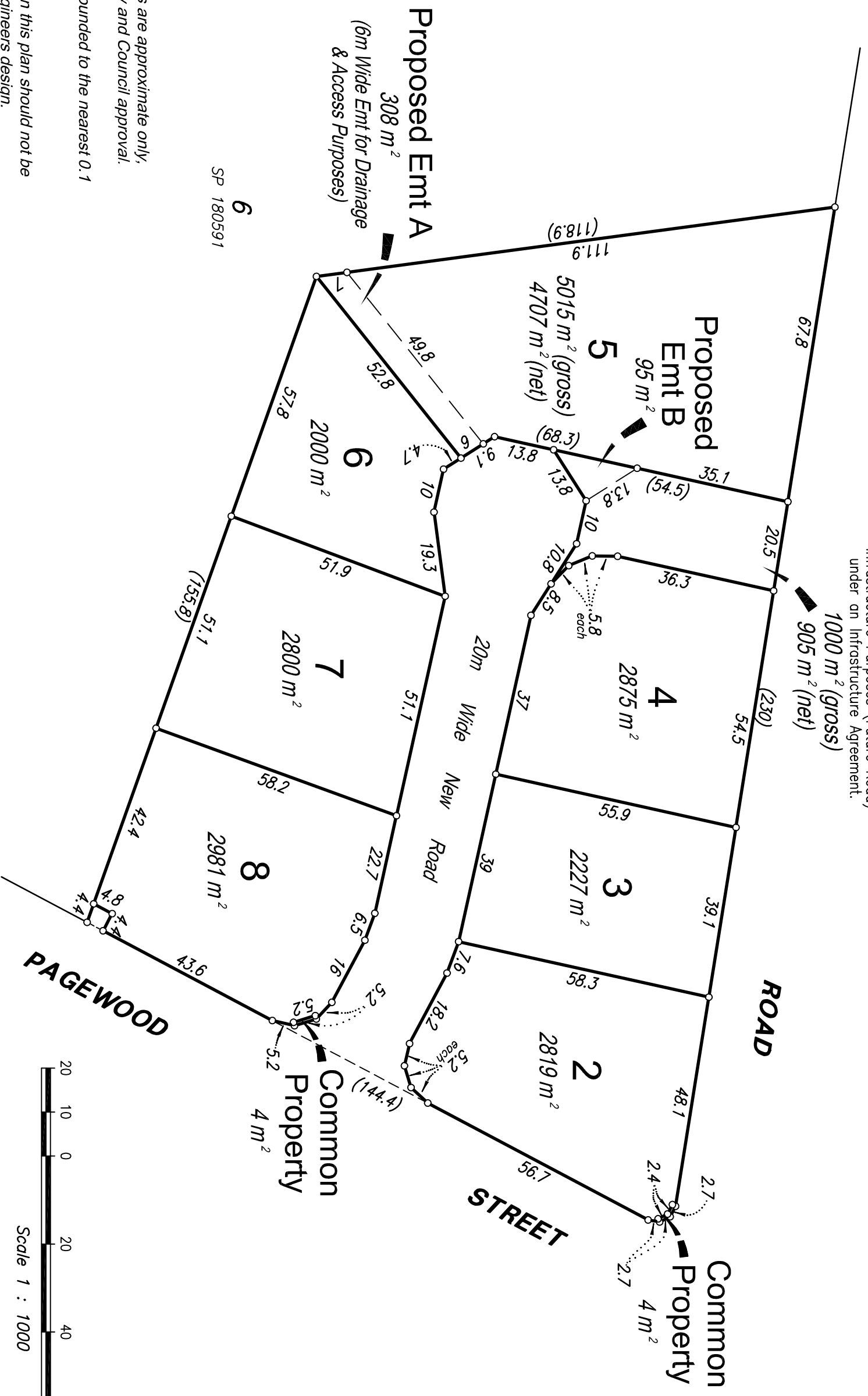

Note  
All dimensions and areas are approximate only,  
and are subject to survey and Council approval.  
Dimensions have been rounded to the nearest 0.1 metres.

The boundaries shown on this plan should not be used for final detailed engineers design.

Level Datum	Date	5 SEPTEMBER 2007
Origin	Surveyed	
	Comp By.	BM
	DWG Name:	20340_Stage1_Pro
Scale	Local Authority	LOGAN CITY COUNCIL
1:1000@A3	Job Reference	20340-001

CLIENT	PROJECT
<b>YUSUF PTY LTD</b>	<b>LOGANLINK SOUTH INDUSTRIAL PARK STAGE 1</b>
OVER LOT 90 ON SP 180591 WEMBLEY ROAD, BERRINBA	Plan Reference <b>20340-33E</b>

PROJECT	Plan Reference
<b>LOGANLINK SOUTH INDUSTRIAL PARK STAGE 1</b>	<b>20340-33E</b>

**pmm**  
a comics company

©COPYRIGHT PROTECTS THIS PLAN  
Unauthorized reproduction or amendment  
not permitted. Please contact the author.

PMM BRISBANE PTY LTD  
A.C.N. 010370448  
A.B.N. 81591046888  
743 Ann Street, Fortitude Valley,  
PO BOX 1559,  
FORTITUDE VALLEY QLD 4006.  
TELEPHONE 07 3237 8899  
FACSIMILE 07 3237 8833  
email: pmm@pmm.com.au  
web: www.pmm.com.au